

NOTES

1. This drawing has been produced based on the latest MK highway model - Draft Design Freeze D/F1, as provided by the client (July 2015).
2. This drawing has been produced mainly for the purpose of preliminary design and planning.
3. Levels are in metres and above Ordnance Datum.
4. All dimensions are in millimetres.
5. The option shown in this drawing is not for construction.
6. The foundation type shown on the drawing is based on the latest available geotechnical information.
7. Basic preliminary design has been undertaken to determine the geometry of the section sizes as per client's instruction.
8. Concrete strengths:-
 Precast panel C37/ 40
 Abutment C40/ 50
 Deck slab C40/ 50
 Parapet edge beams C40/ 50
 Precast beams C50/ 60
9. Permanent formwork is required.
10. Concrete finishes to be as per MCHW specification series 1100 UNO :-
 Buried foundations : F1, U1
 Abutment : F1, U1
 Buried face of abutment : F1
 Waterproofing : F4,
 Precast beams : F4, F5,
 Precast concrete panel : F4,
 Parapet edge beam : F3, U3
 Deck slab top surface : U1,
 U4.

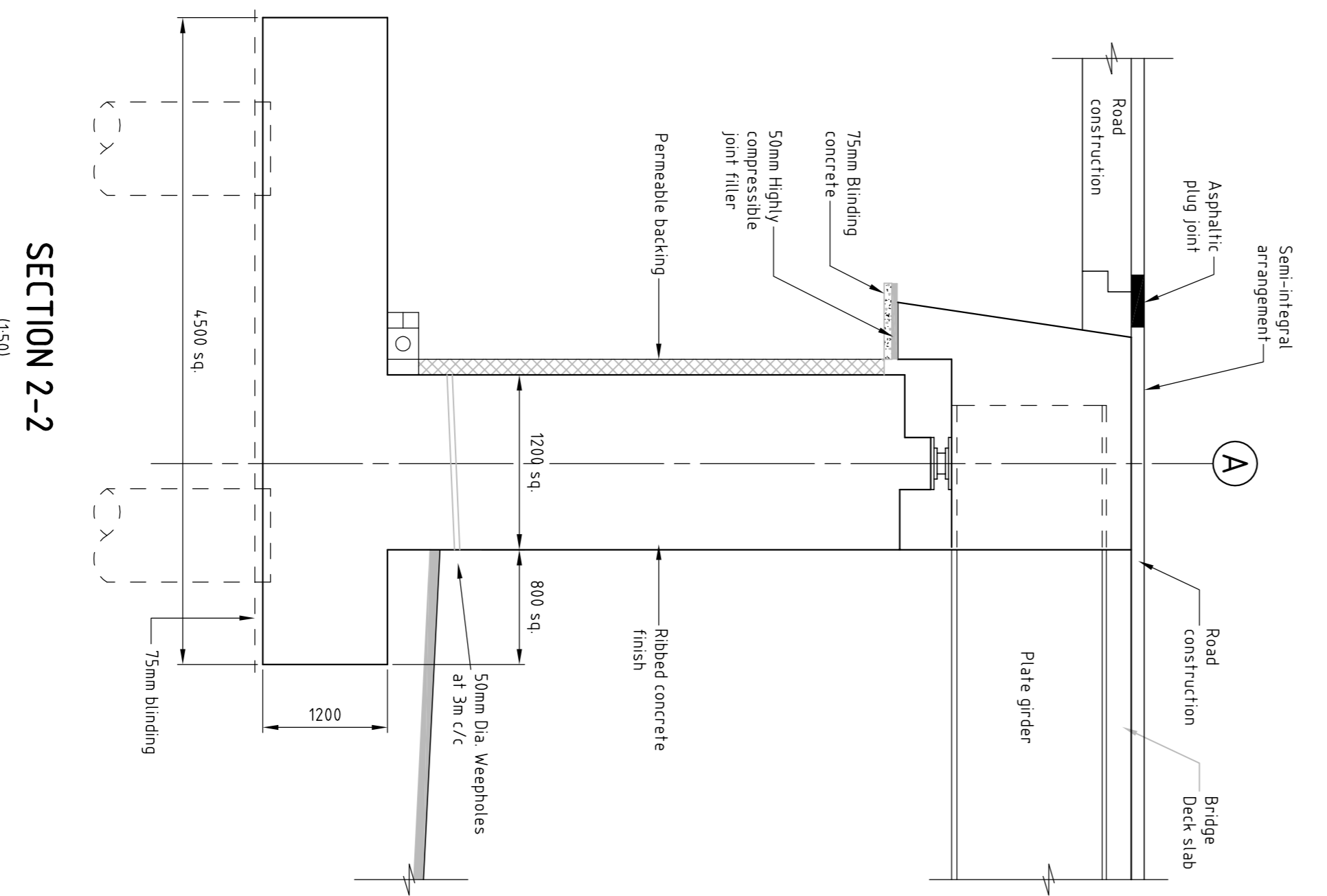
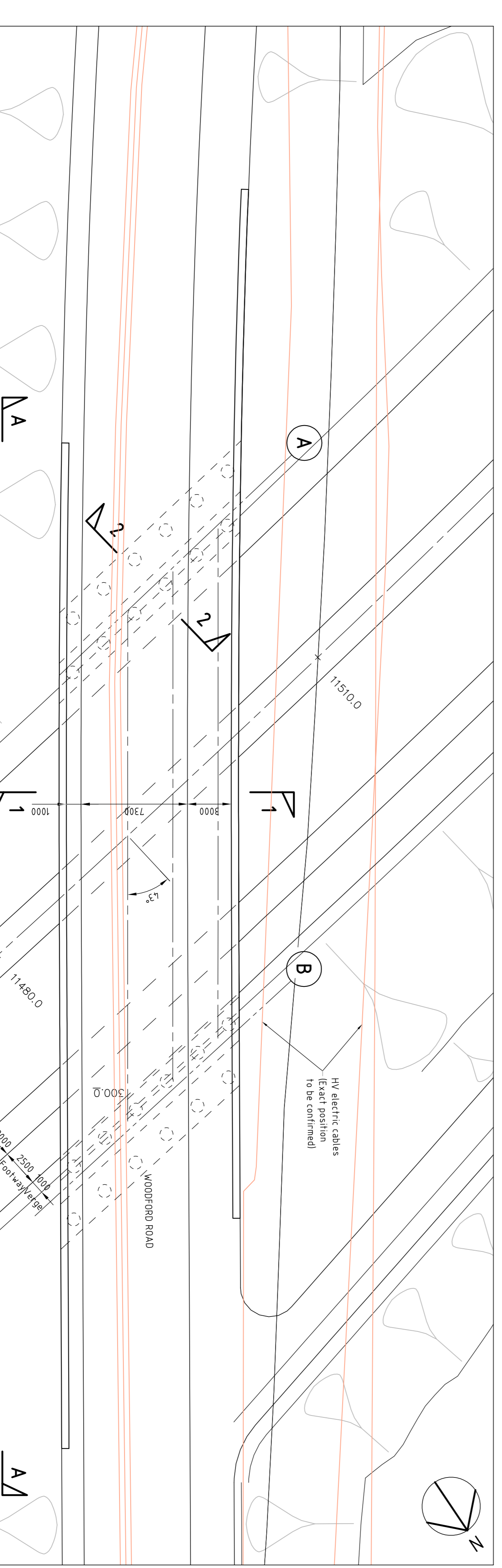
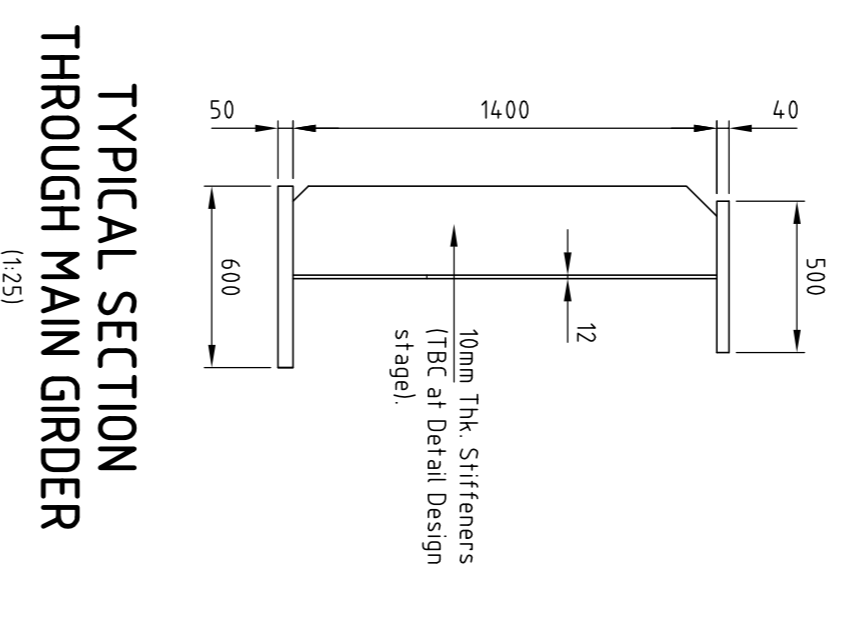
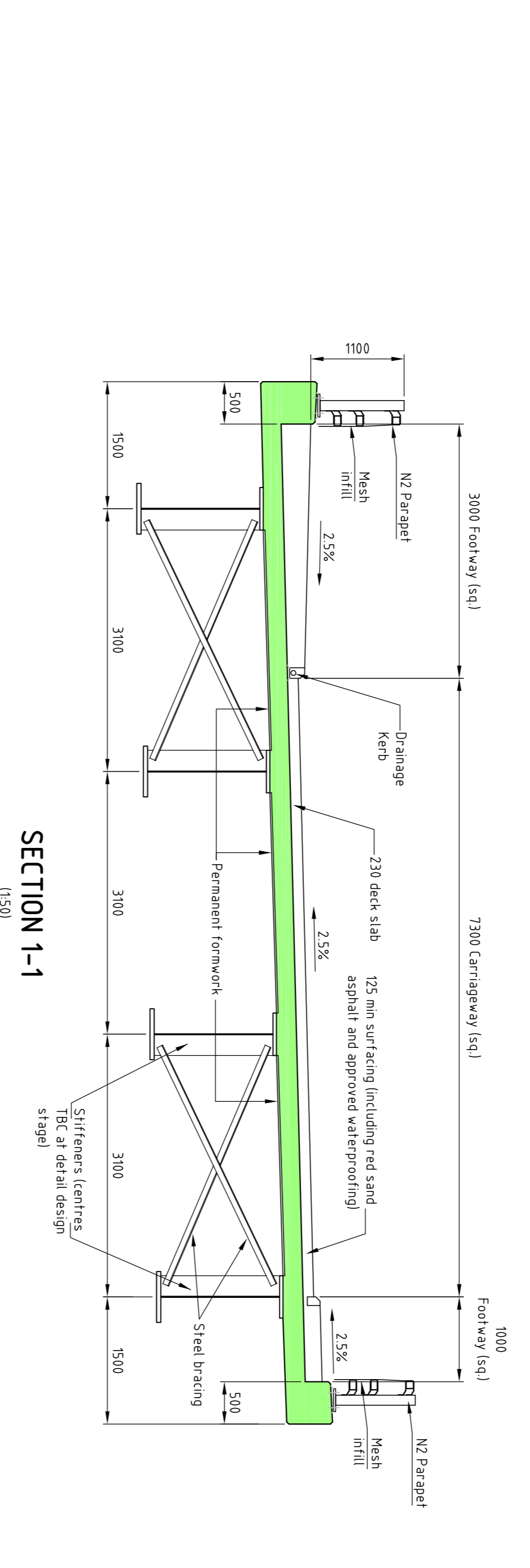
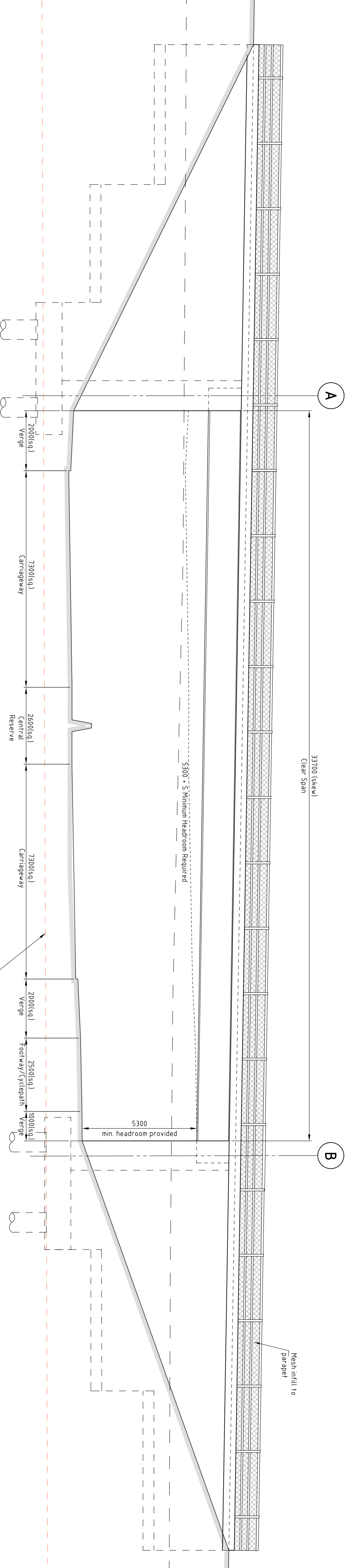

WOODFORD ROAD BRIDGE GENERAL ARRANGEMENT

B007

A6 TO MANCHESTER AIRPORT RELIEF ROAD

Drawn	Engineer	Checked	Approved
BDJ	LF	LF/NS	NS
Date	Date	Date	Date
DEC '11	DEC '11	DEC '11	DEC '11
Scale	AS SHOWN		
Size	A1		
SCG No.	Filename		

semms

STOCKPORT MANCHESTER CITY COUNCIL

Jim Madson BSc, CEng, MSc
 SENIOR PROJECT MANAGER

Paul Perry, C/O Stockport House
 SENIOR PROJECT MANAGER

Job Title

Drawing Title

Drawing No. 1007/3D/DF7/A6-MA/B007/707

Revision C